

DR Rack with monitor mount

Ref. No. 200.000.092

The DR rack owes its superior stability not only to its low center of gravity, but also to the fact that its casters protrude beyond the body of the rack.

The DR rack makes use of an additional isolating transformer, which ensures optimal power supply.



Features

- The power chases, sited at the sides of the support column, conceal and protect data and electrical cables.
- Various compartments within the chases permit separation of cable runs and accommodate excess lengths of cabling without difficulty.
- Ample space is present for sockets of varying sizes along the entire length of the chases.
- An on-and-off switch can also be integrated into the right-hand chase.
- Rubber lips permit unimpeded entry and exit of cabling along the entire length of the chases.
- The smooth surfaces permit rapid and hygienic cleansing and disinfection.

Technical parameters

Legend

- 1 Infusion stand
- 2 Adjustable monitor mount
- 3 Shelf (450 x 491 mm), maximum load 50 kg
- 4 Shelf (450 x 491 mm) with handle, maximum load 50 kg
- 5 Shelf (450 x 491 mm), maximum load 50 kg
- 6 Upper surface of drawer housing
- 7 Drawer Dimensions (width x height x depth) 450 x 96 x 491 mm
Internal dimensions (width x height x depth) 360 x 85 x 400 mm
- 8 Caster with stabilizers
- 9 Keyboard drawer with mousepad (drawer left and right).
Dimensions (width x height x depth) 450 x 96 x 491 mm.
Maximum keyboard width 407 mm
- 10 Camera mount
- 11 Foot pedal bracket
- 12 Insulating transformer
- 13 On-and-off switch

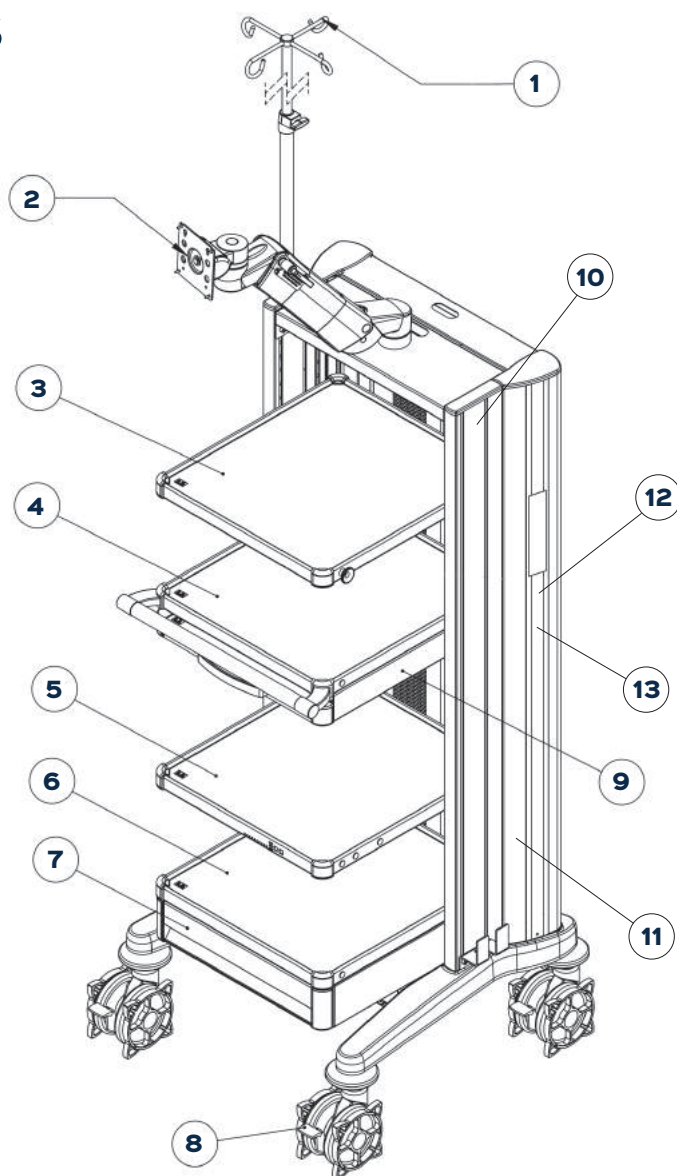

Dimensions (mm)

Weight approximately 120 kg

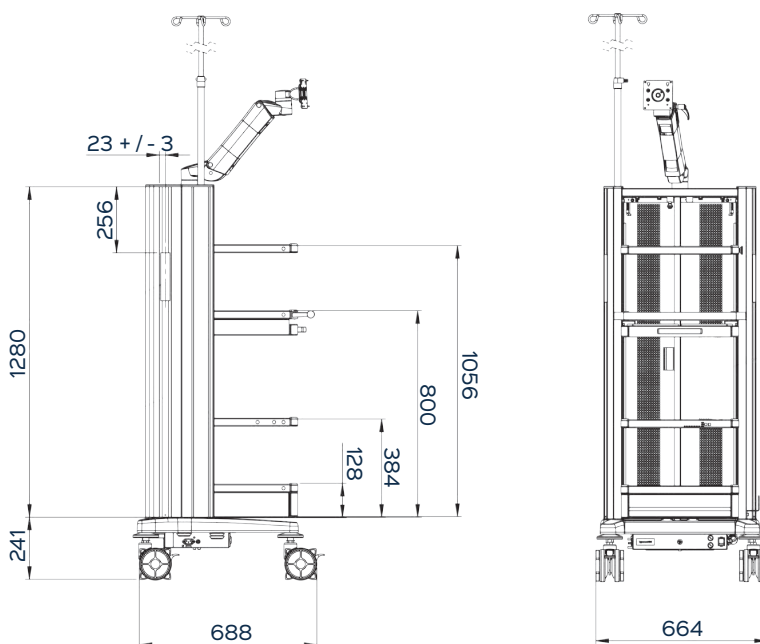

Version001_EN